

上ぶた式U形側溝(本体) 2種(JIS A 5372)

U180~U450

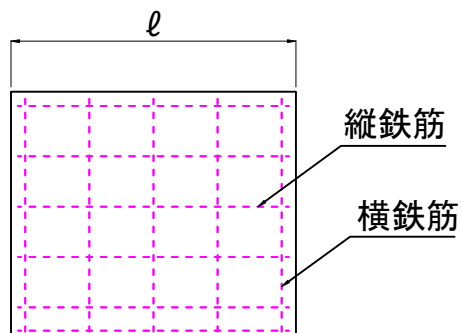

U600のみ

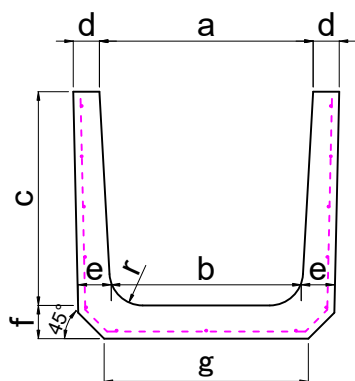
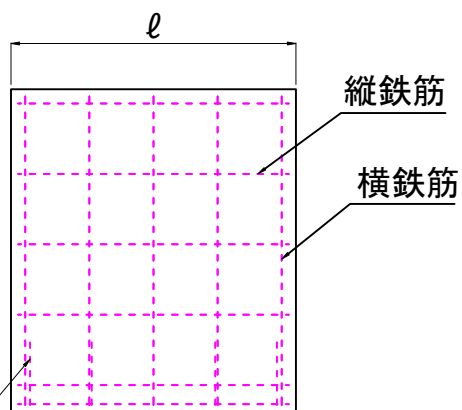
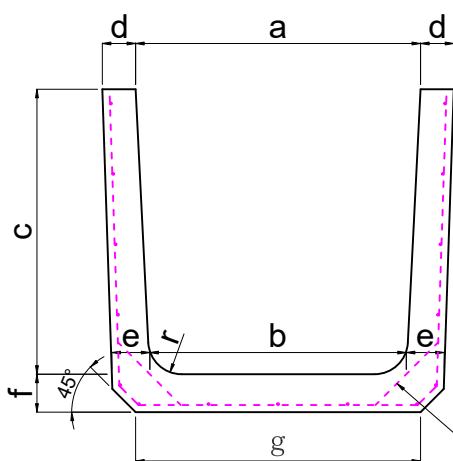

用心鉄筋 $\Phi 6.00 \times 4$ 本

●寸法表

呼び	寸法 (mm)									配筋				参考重量 (kg)	曲げひび割れ耐力 (kN·m/m)
										縦鉄筋		横鉄筋			
	a	b	c	d	e	f	g	r	l	径又は呼び	数量	径又は呼び	数量		
180	180	170	180	35	40	40	190	50	600	4.0	5	6.0	9	33	0.816
240	240	220	240	45	50	50	240	50	600	6.0	7	6.0	9	53	1.266
300A	300	260	240	50	60	60	300	50	600	6.0	9	D10	5	68	1.770
300B	300	260	300	50	60	60	300	50	600	6.0	9	D10	5	77	1.770
300C	300	260	360	50	60	65	300	50	600	6.0	11	D10	5	89	2.083
360B	360	310	360	50	65	65	360	50	600	6.0	11	D10	5	97	2.066
450	450	400	450	55	70	70	430	70	600	6.0	13	D10	5	130	2.533
600	600	540	600	70	80	80	600	70	600	6.0	15	D10	5	204	3.208